



670 Archerfield Road Inala, QLD



ALL PROPERTIES GROUP & CHRIS GILMOUR SOLD?

SOLD BY CHRIS GILMOUR 0438 632 459

This home is set directly opposite a picturesque reserve and is absolutely bursting with potential. You might choose to make some updates, modernise the interior and add instant value or enjoy the home as-is as your idyllic family abode or low-maintenance investment, the sky's the limit when it comes to 670 Archerfield Road.

From the covered front deck, you are welcomed into the open-plan and air-conditioned kitchen, lounge and dining zone. This will be a favourite place to gather with the family as the eager cook gets creative in the light-filled and well-equipped kitchen with a freestanding cooktop, a dishwasher and plenty of storage.

Disclaimer:?

All information provided has been obtained from sources we believe to be accurate, however, we cannot guarantee the information is accurate and we accept no liability for any errors or omissions (including but not limited to a property's land size, floor plans and size, building age and condition) Interested parties should make their own enquiries and obtain

\$518,000

Type: House

Sold Date: Saturday, 13th November 2021

Land: 612 m2



Chris Gilmour

0438 632 459



Megan Leberherz

0475 631 166

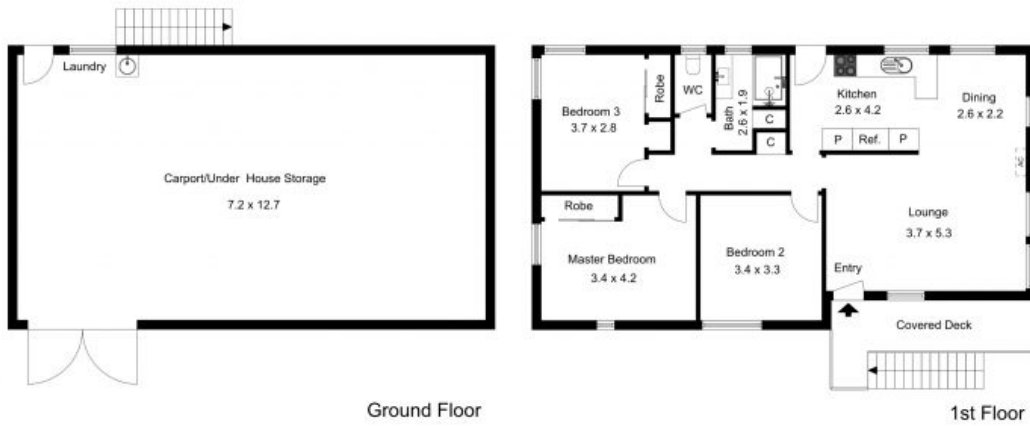

The floor plan is not to scale; measurements are indicative and in metres. Exterior elements are not in position. Plans should not be relied on. Interested parties should make and rely on their own enquiries.