



26 Regal Drive Regents Park, QLD



CURRENTLY AVAILABLE FOR INSPECTION

With a lush treetop outlook from the spectacular nature reserve at your doorstep, this spacious and inviting family residence provides the perfect indoor/outdoor lifestyle.

Immaculately presented on a sprawling 659m2 grounds in a quiet family-friendly street, yet just metres from fabulous local amenities and walking distance to Yugumbir State School, the spacious four-bedroom residence is sure to impress with its family-friendly design and fabulous entertaining options.

Large porcelain tiles deliver a sense of style, whilst warm undertones creating a soft and welcoming ambience. The kitchen is well-appointed, with the timeless yet sophisticated appeal of simple elegant cabinetry and distinguished gold highlights adding a touch of flair.

Offering two indoor entertaining areas, you are spoilt for choice for areas to relax and unwind and spend quality time with loved ones. Plus, a family can appreciate the benefits of two separate television areas!

This safe and central address sits within easy walking distance of bus stops, Yugumbir State School, in close proximity to High schools, Grand Plaza shopping centre and offering am

\$429,000 +

Type: House
Land: 659 m2



Derrick Williams

0433 005 324



Chris Gilmour

0438 632 459

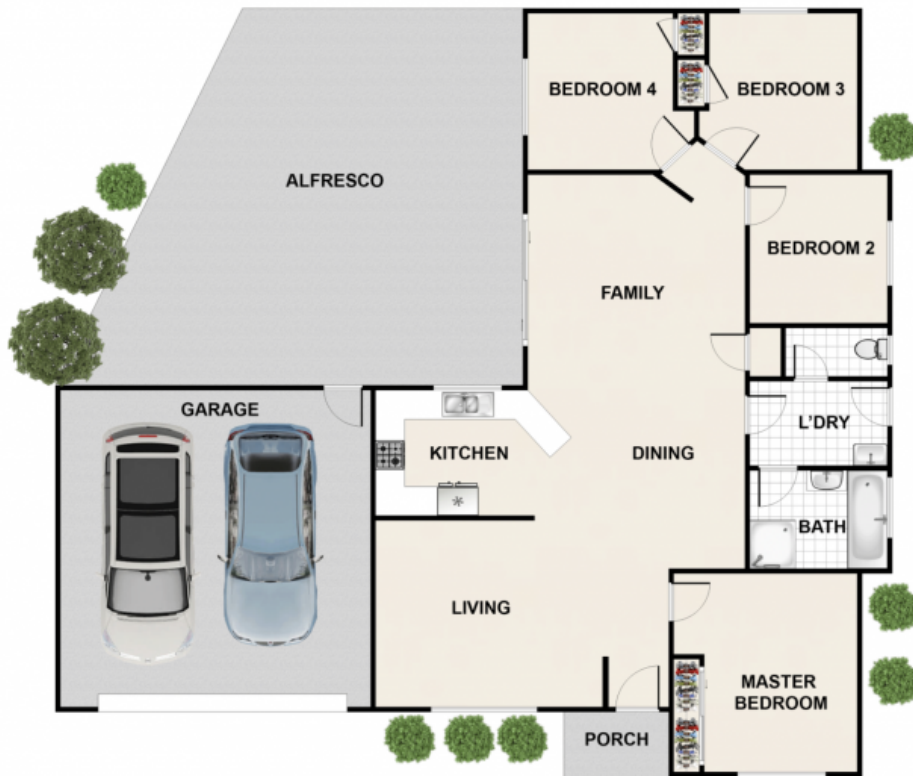

Approx Sqm
 Inside Areas - 170 Sqm
 Outside Areas - 60 Sqm
 The Total Areas - 230 Sqm



26 Regal Drive, Regents Park

Whilst every attempt has been made to ensure the accuracy of the floorplan shown, all measurements, positioning, fixtures, fittings and any other data shown are an approximate interpretation for illustrative purposes only and are not to scale. No responsibility is taken for any error, omission, mis-statement or use of data shown.